

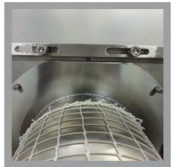

Simple all pneumatic operation, no electrics.



Designed to take standard collagen rolls.



Secure tube location

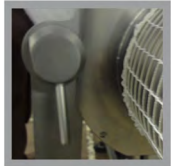

Camlock tube location, making even bent tube removal easy.

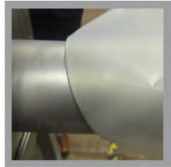

Smooth collagen former easily changed without tools.



Collagen former with cut out sections for less friction and easy film feeding.



TECHNICAL INFORMATION
Speed

The machine will cycle over 600 times per hour.
 Production speeds will depend on the product and the input and output flows to and from the machine.

Weight

Approximately 130 kilos

Services
Compressed Air

80 psi or 5.5 bar
 50ft³ or 1500 litres per minute

Packing Crate Dimensions

Length 2500mm x Width 760mm x Height 1500mm

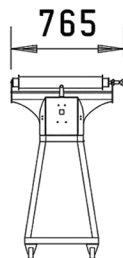
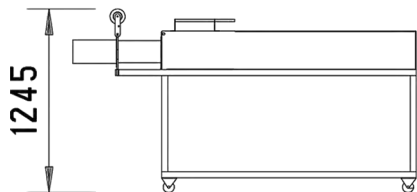
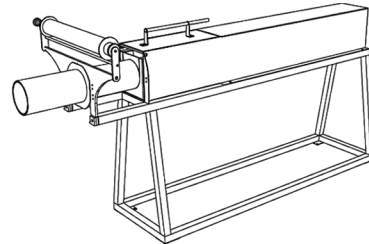
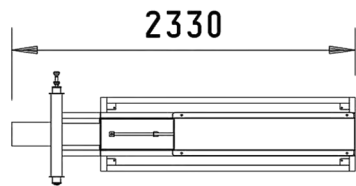
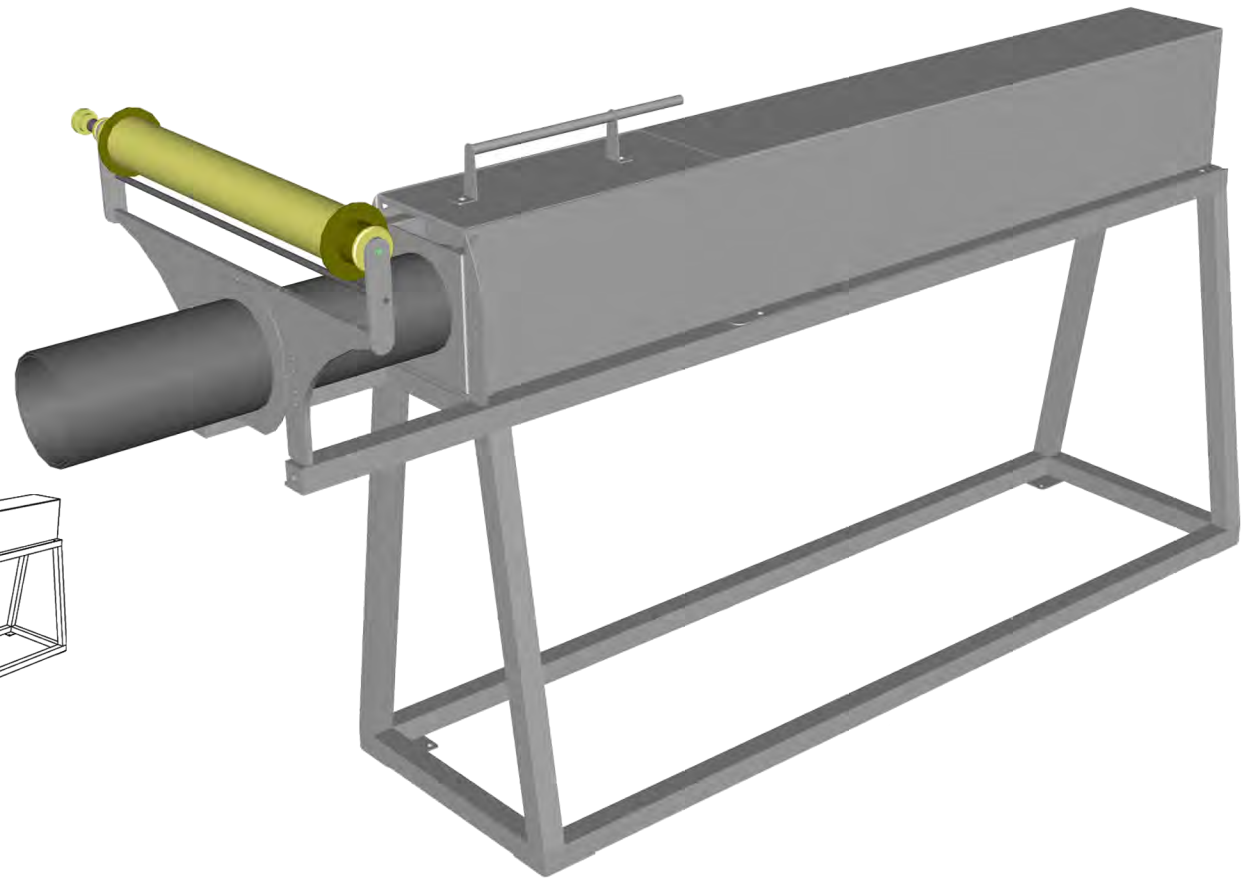

Please note dimensions are subject to change without notice.



Compliant with the latest safety standards

All contact parts manufactured from 316 Stainless Steel – safe for food contact.

T +44 (0) 1355 244244 E info@scotnetsolutions.com | www.scotnetsolutions.com